

■ Important Safeguards

- Do not use this product if you have not received a formal induction from your therapist. As a primary carer please ensure you are aware of your responsibility relating to the safe use of this product
- This product has been prescribed by the Therapist or practitioner who should have adjusted the Nano to meet the child's need. If this product has not been adjusted by the therapist please do not use it.
- It is imperative that the product log form is completed at the rear of this manual on a regular basis. This form must be used to record setups, changes to the product and scheduled maintenance checks undertaken.
- To validate the warranty it is important that each section of the end user manual is actioned, recorded and initialled each time Nano is reviewed.
- Please ensure this manual is kept in a safe place.
- CARE, MAINTENANCE AND CLEANING procedures must be followed in this manual to ensure client well being.
- It is imperative as a primary carer that you understand the CORRECT USE of the product and also what is INAPPROPRIATE USE.
- Secure the child using the trunk, pelvic and footstraps immediately .
- Always use all of the positioning straps provided.
- Please ensure that the product is used on an indoor even surface at floor level.
- It is imperative that children are continuously monitored whilst using this equipment. **NEVER LEAVE A CHILD UNATTENDED IN THIS PRODUCT.**



PO.Box 2125 Wolverhampton, WV6 7FB
Tel / Fax +44 (0) 121 523 5004
Tel / Fax +44 (0) 1902 741675
E-mail: enquire@a2u.co.uk
Website : www.a2u.co.uk



■ Nano



End User manual

This manual contains essential guidance for therapists and stores personnel. This manual must be read thoroughly before issuing this product to an end-user.



Do not use this product if you have not received a formal induction from your therapist. As a primary carer please ensure you are aware of your responsibility relating to the safe use of this product

Product Induction

- This product has been prescribed by the Therapist or Practitioner who should have adjusted the Nano to meet the child's need. If this product has not been adjusted by the therapist please do not use it.
- Before using the product please ensure you have had a product induction from your therapist. Formal induction plan is shown on page 13.
- It is imperative that you understand the responsibility you are taking as a primary carer.
- Please ensure this manual is kept in a safe place.
- It is imperative that the product log form is completed by your therapist at the rear of this manual on a regular basis. This form must be used to record setups, changes to the product and scheduled maintenance checks undertaken.
- It is imperative as a primary carer you understand the CORRECT USE of the product and also what is INAPPROPRIATE USE.
- You must understand and appreciate all SAFETY aspects of a2u products.
- CARE, MAINTENANCE AND CLEANING procedures must be followed to ensure client well being.
- DO NOT undertake any adjustments unless directed by the Therapist, please contact your Therapist for directions.
- CARERS AND HOME USERS MUST BE AWARE. This product has been prescribed by the Therapist or practitioner for a specific child and should ONLY be used as directed by the prescriber.

Important Issuing Information

This form **must** be completed on issue or re-issue of the product

Child's Name	
Therapist Name	
Address	
Telephone	
Primary Carer's Name	
Product Issue Date	
Product Serial No.	
Product Purchase Date	

Induction Check List

Please ensure that the following sections are covered with the primary carer before the product is issued. Please initial each box when instructing carer / end user through the induction process.

Safety Information	
Daily User Guide	
Care & Maintenance	
Cleaning	
Product Log Updated	

Induction Given By

Induction Received By

Using Nano

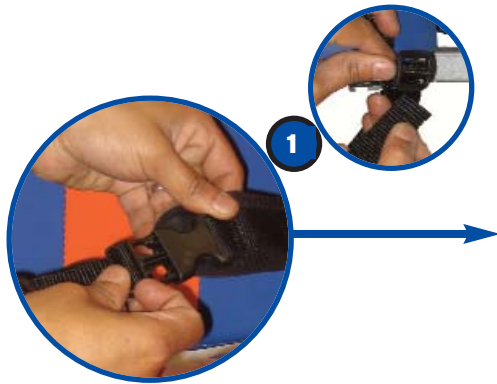

Pelvic Strap Adjustment

It is imperative that the pelvic buckle is positioned in the centre of the seat. Once the buckle is fitted together, pull the D loops to enhance a more secure fitting. To release place fingers under each side of buckle and gently pull from side to side. This will release the side webbing and enable easier access. The pelvic strap is designed to fit across the pelvis NOT around the waist. The length of the lapstrap can be adjusted through the triglide under the seat. ❶

- Always secure the strap first before making any other adjustment.
- Readjust strap to allow for changes in clothing and change of child.
- Check that the straps go under the pelvic support and that they fit snugly at ALL times to maintain correct seating position.
- Regularly check pelvic strap is fitted snugly and adjust accordingly.

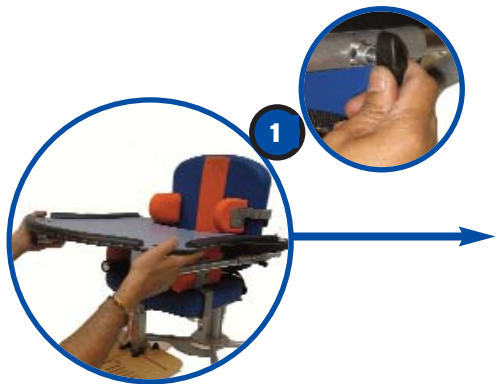

Tray & Armrest Adjustment

The tray slides into the round tubing on the armrest. The wing knob on the side of the armrest locks the tray in place ❶.

Do not leave child unattended in Nano.
Always use positioning straps provided.

Nano Specification

	Nano	
	mm	inches
Seat Depth		
Min	190	7.5
Max	290	11.4
Seat Width		
Min	170	6.7
Max	280	11.0
Seat To Footrest		
Min	160	6.3
Max	280	11.0
Seat to Floor		
Min	280	11.0
Max	400	15.7
Backrest Height		
Min	320	12.6
Max	380	15.0
Overall Base		
Length	900	35.4
Width	510	20.1
User Weight	25 Kg	

- Nano A, (Max User Weight 25Kg).

Warranty

- a2u warrants that equipment sold by a2u will be free of all defects in material and workmanship for a period of 2 years from the date of purchase. We will not be held responsible for any damage, injury due to misuse or modification of our products.
- a2u will repair or replace, at our discretion, any equipment or parts proving defective within the terms and period of this warranty.
- If any part of the equipment is found to be defective within the terms and period of this warranty a2u will, at its own discretion, repair or replace it.
- For advice on the use of this product please phone our after sales line on + 44 (0) 121 523 5004.

Using Nano

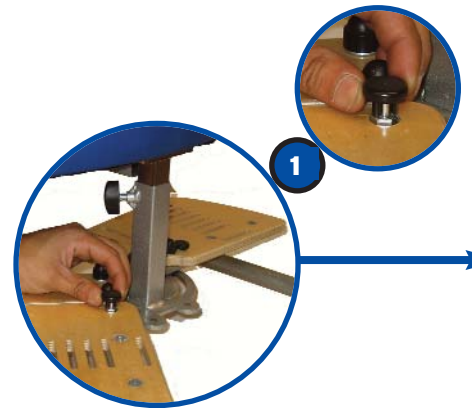

Footrest Adjustment

Nano footrest is designed to swing away to assist transfer. To swing the footplate back, pull and rotate the two plungers located on either side of the frame, ①. Once the plungers are in the outwards position the footplate can be swung away. To relocate, rotate the footplate towards the middle and lock the two plungers so they snap back into inward position. Please ensure both the plungers are completely in inward position after each transfer.

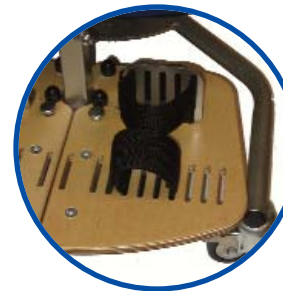

Heel Bar & Foot Straps

To adjust the position of the foot and ankle straps, simply select the most appropriate slot for position and feed the straps through.

Do not leave child unattended in Nano.
Always use positioning straps provided.

Using Nano



Dynamic Zip Jacket

The shoulder straps are fitted by two flip up buckles at the top of the backrest ❷. The lower straps are fitted in the desired position to the lapstrap fixing plate ❶. Pull the D loop on the lower straps to tension the jacket. The jacket is removed by unzipping and then removing the two upper buckles on the backrest. When putting jacket on fasten the zip first, pull on D ring to ensure a secure fit as low as possible on the torso. Lastly secure webbing. Check that jacket is fitted low down so that material does not ride up towards child's throat.

Do not leave child unattended in Nano.
Always use positioning straps provided.

Maintenance

This product has been prescribed by the Therapist or practitioner who must ensure that all users understand and implement correct use, safety checks, care, maintenance and cleaning. It is the user (carer for the child) who is responsible for ensuring the product is correctly used on a day to day basis. The Therapist should direct the following checks to be undertaken, the frequency of the check is only a minimum and should be adjusted depending on the environment in which the equipment functions.

Daily Checks

- Check that supports and straps are securely fixed.
- Check that the pelvic strap fits the child snugly.
- Check all upholstery for wear and tear.
- Check framework for wear and tear, splinters, breaks.

Monthly Checks

The monthly check, again the frequency is only a minimum and should be adjusted depending on the environment in which the equipment functions. As this check is a more in-depth check a suitably competent individual should be nominated by/on behalf of the prescriber.

- Check the seat height fixings are secure and tight.
- Check the two screws which enable seat depth adjustment are secure and tight.
- Check that supports and straps are functionally correct and securely fixed.
- Check that all the supports are secure and tight.
- Report any missing or worn bolts/fixings to the therapist.
- Check straps for fraying and missing or broken buckles.
- Check all upholstery for wear and tear.
- Check framework for wear and tear, splinters, breaks.
- Check the overall structure of the Nano for any signs of fatigue or damage.
- Ensure end user log is updated.

Cleaning

- Metalwork and coated parts can be wiped with soapy water or antibacterial spray. Please dry the product thoroughly. Please do NOT use solvents, abrasive cleaners, caustic soda, sodium hypochlorite and organic solvents.
- All padding should be wiped regularly with soapy water or antibacterial spray. Please dry material thoroughly after wiping. Please do not soak the fabric.